

3011

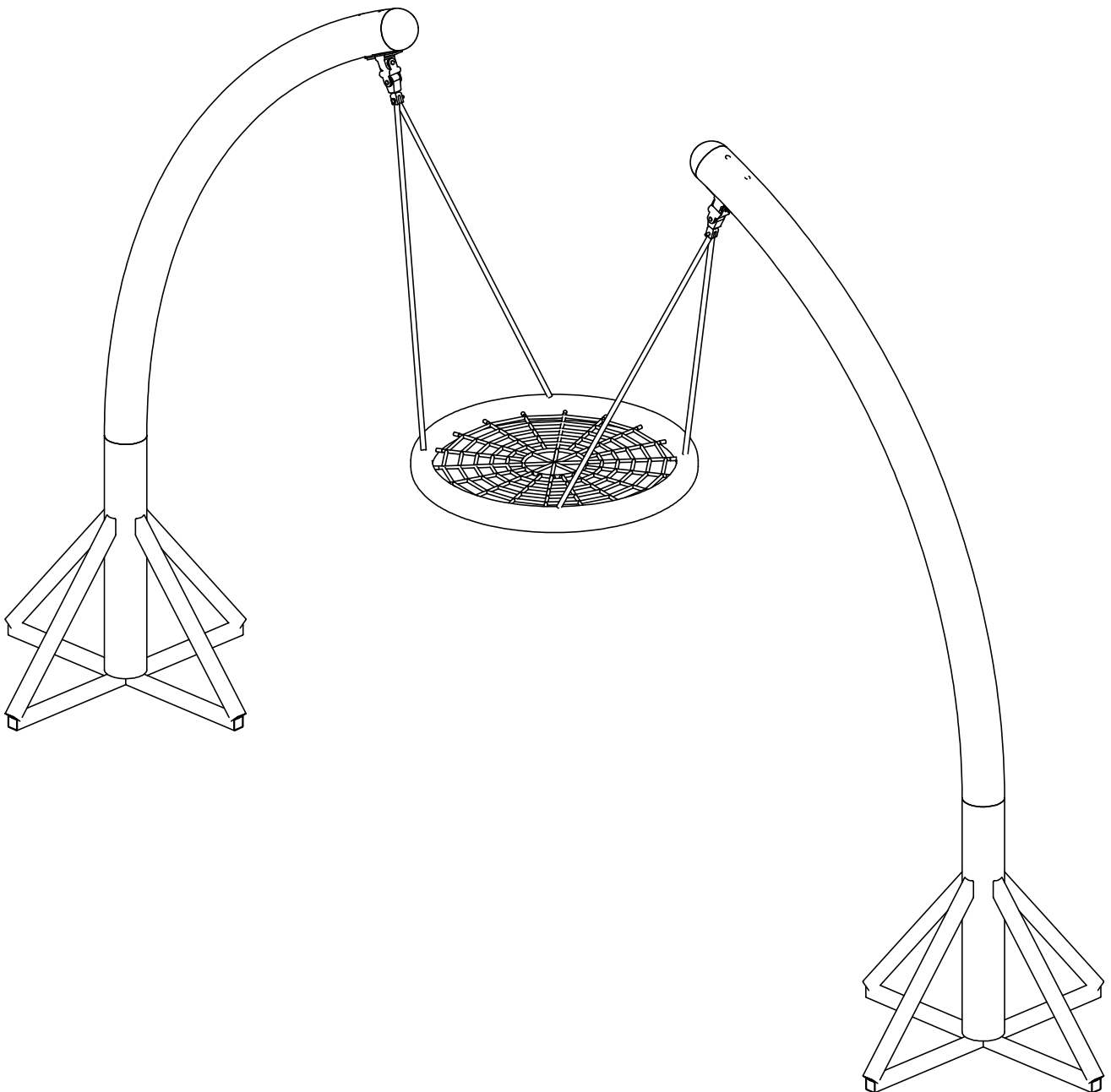

<div data-bbox="49 51 118 107" data-label="Text"><p>E1</p></div> <div data-bbox="70 62 344 479" data-label="Image">A line drawing of a curved arm structure. It has a triangular base with a central vertical post. A curved arm extends from the top of the post, arching upwards and to the right. At the end of the arm is a small hook-like detail. Below the base, the text 'H=267cm' is written.</div> <div data-bbox="119 510 280 546" data-label="Text"><p>H=267cm</p></div> <div data-bbox="347 517 413 566" data-label="Text"><p>x2</p></div>	<div data-bbox="427 51 501 107" data-label="Text"><p>E2</p></div> <div data-bbox="536 179 692 389" data-label="Image">A line drawing of a circular base with a mesh-like pattern. Two vertical lines extend upwards from the base, forming a V-shape. The top of the V is open.</div> <div data-bbox="722 517 785 566" data-label="Text"><p>x1</p></div>		

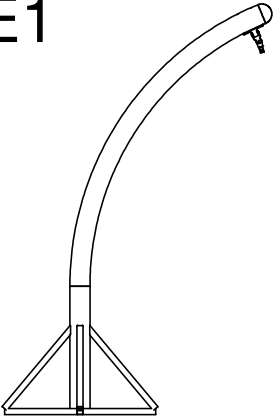

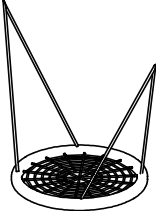
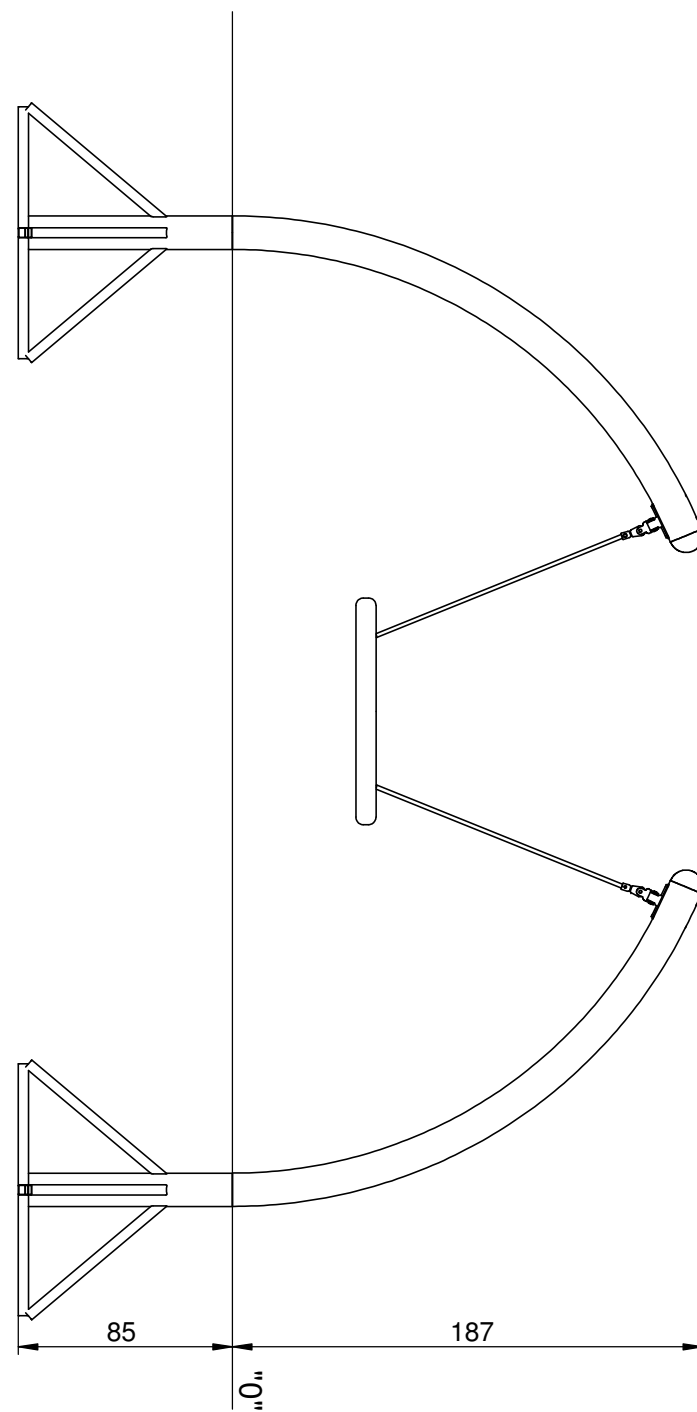
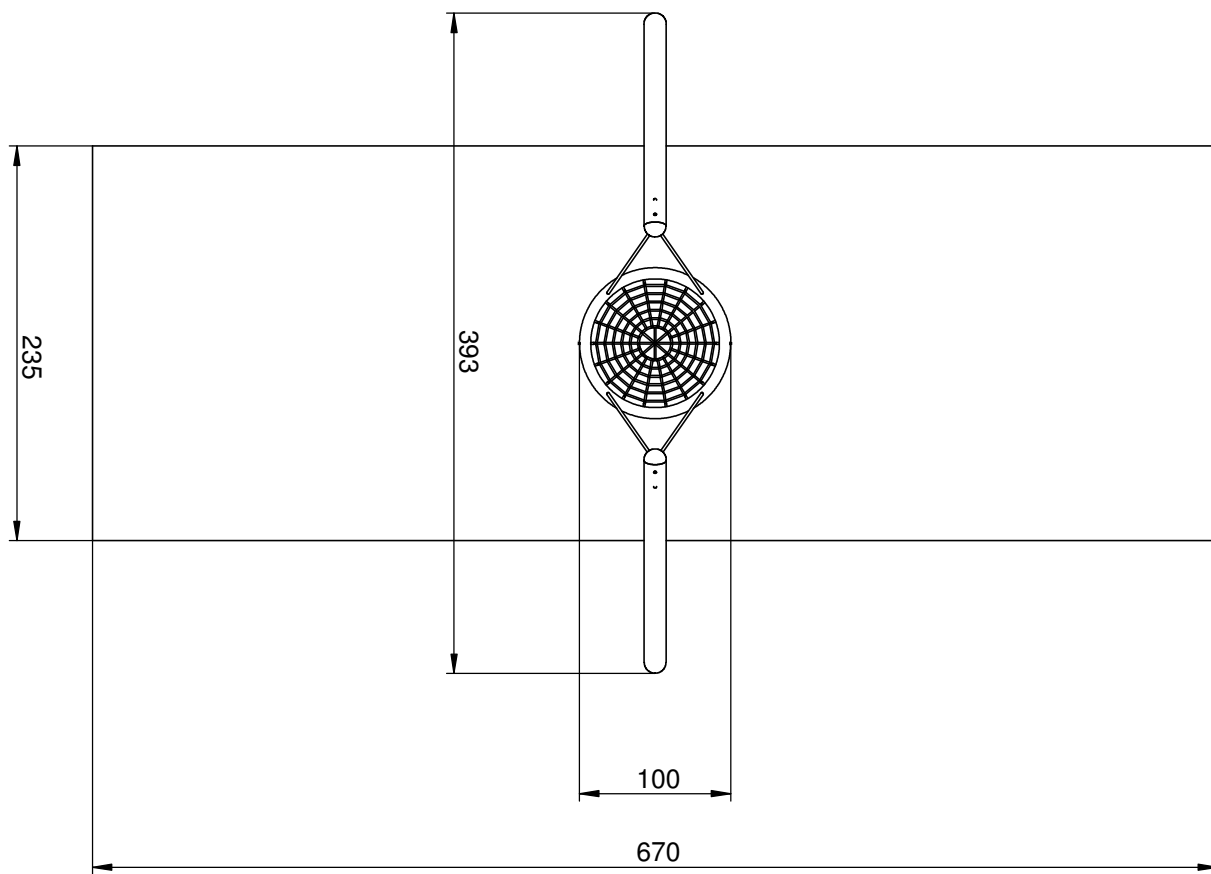
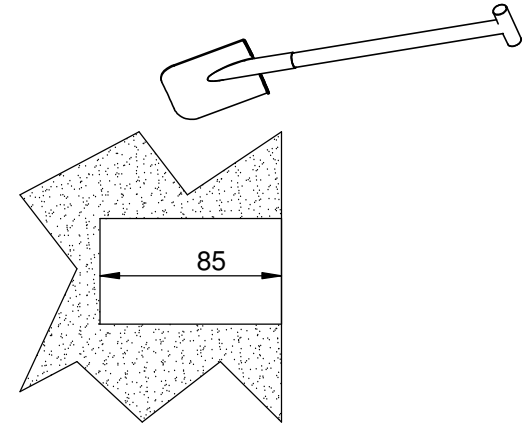
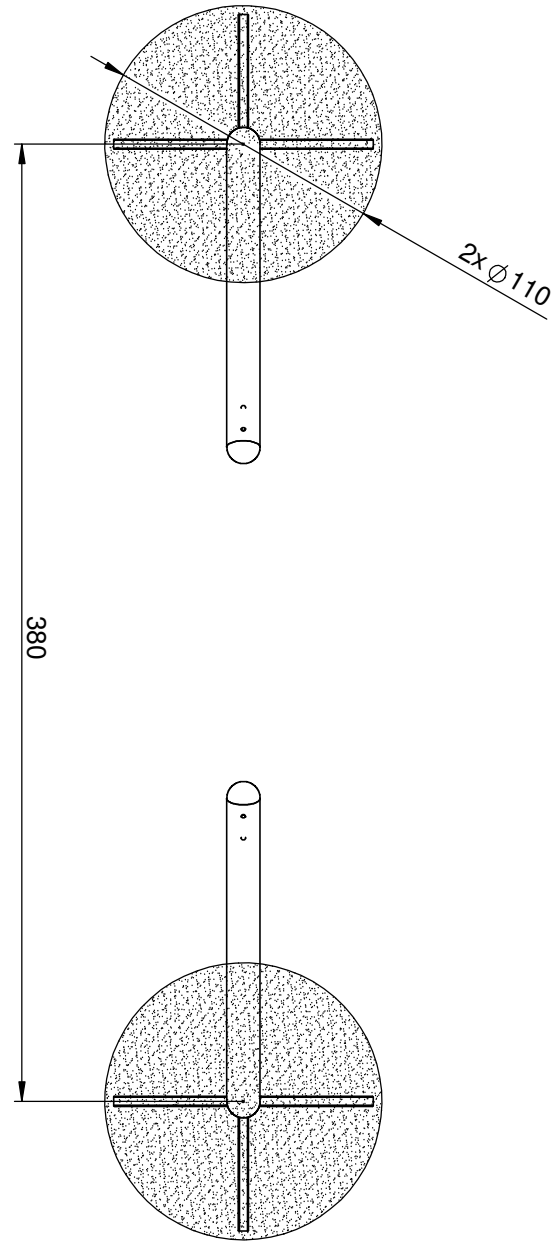

2

B25 1m<sup>3</sup>

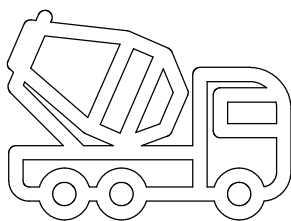

min. 24H

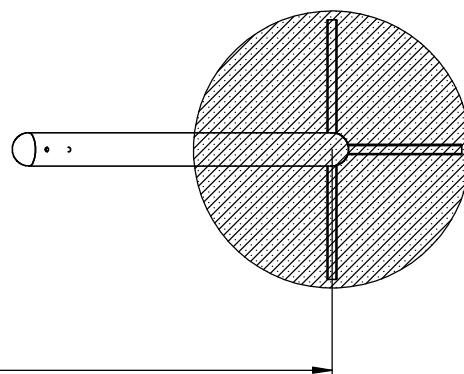
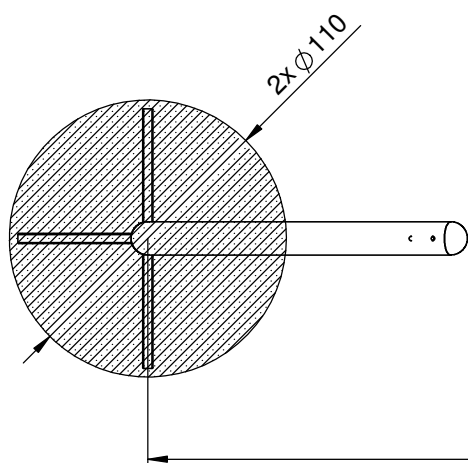
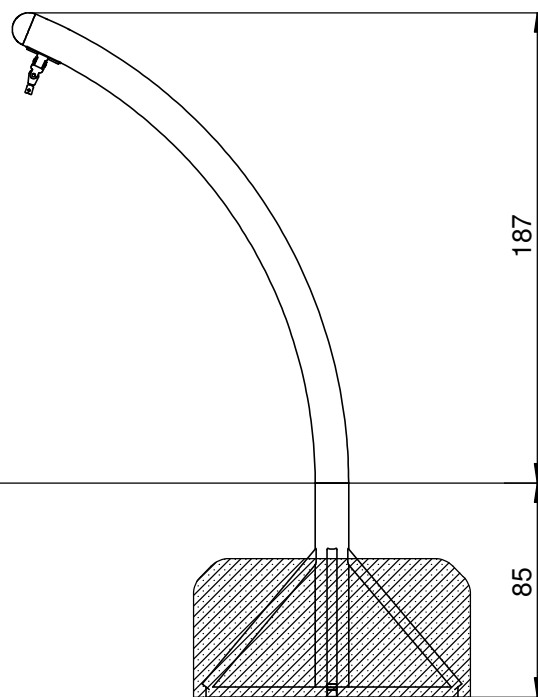
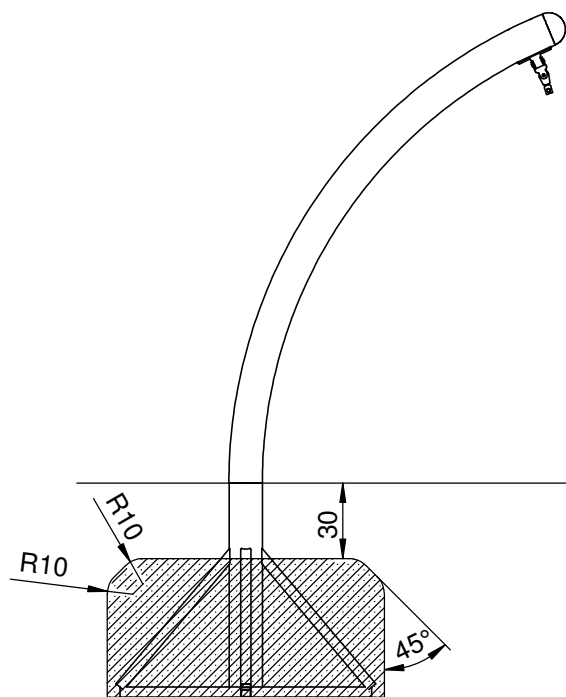
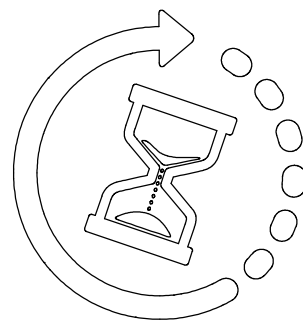

380

3

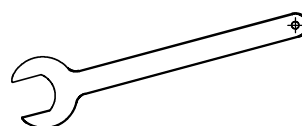
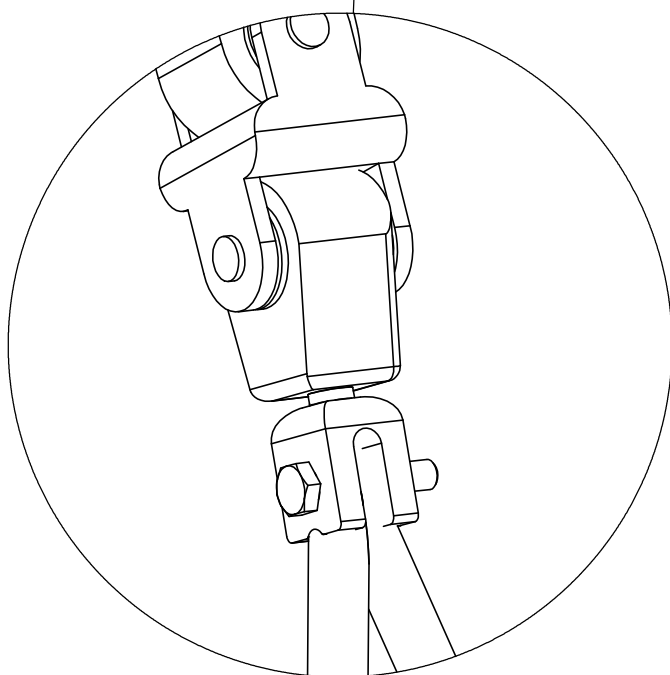
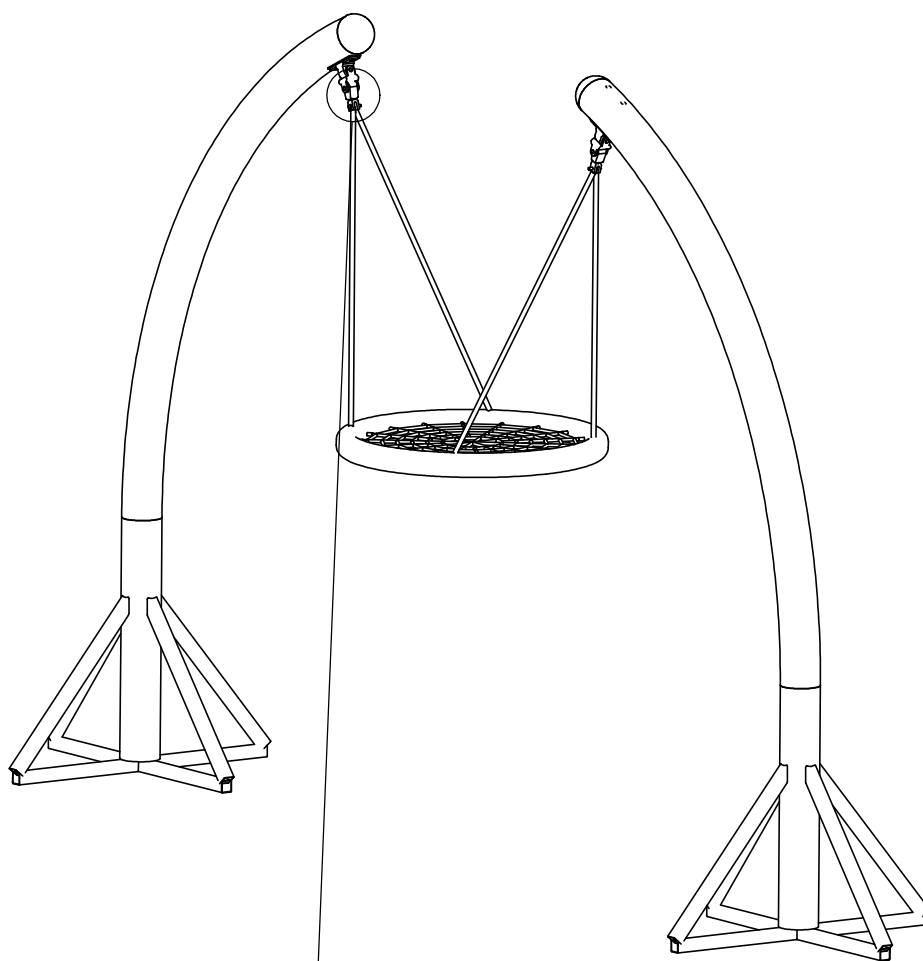

nr.13